

AREA CODE 908

Mayor's Office-226-7601
Administrator/Clerk-226-7606
Assessing-226-7623
Building Dept.-226-7640
CFO-226-7602
Computer Services-226-7649
Emergency Mgmt.-226-7718
Eng./CME Assoc.-732-727-8000
Environmental-226-7621
Finance-226-7615
Fire Official-756-4761

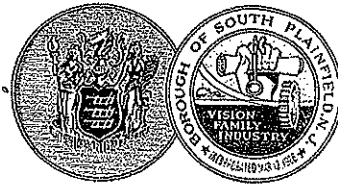

BOROUGH OF SOUTH PLAINFIELD
2480 Plainfield Avenue
South Plainfield, NJ 07080

AREA CODE 908

Health-226-7630
Library-754-7885
Municipal Court-226-7651
Plan Bd/Bd. of Adj.-226-7641
Police-755-0700
Public Works-755-2187
Recreation-226-7713
Recycling-226-7621
Social Services-226-7625
Tax/Sewer-226-7610
Senior Center-754-1047

GUIDELINES FOR FINISHED BASEMENTS IN ONE FAMILY HOMES

- 1) No summer kitchens in the basement without signing second stove agreement.
- 2) No bedrooms in the basement without an egress size window in each sleeping room.
- 3) Plans submitted shall include entire basement floor plan including partitions, door sizes, windows, stairways, guardrails, graspable handrails, closets, utility rooms, electric layout, heating layout, chimney, floor covering, and bathrooms.
- 4) Provide wall cross section including stud size and spacing, firestops, insulation, wall covering material, ceiling material and ceiling height.
- 5) Provide 34" high guardrails on sides of stairs with three or more risers. Guardrails must be designed to withstand a 200 pound concentrated load applied at any point of the guardrail. Guardrails shall be constructed so that a sphere with a diameter of four inches cannot pass through. Graspable handrails shall be 1 ¼ inch to 2 inch diameter.
- 6) Draftstops required in drop ceilings over 1000 square feet. (See sheet). Draftstop material shall be ½ inch gypsum board, 3/8-inch plywood or other approved materials. See detail.
- 7) Provide horizontal and vertical firestops. Vertical firestops required at 10' intervals. Firestops shall be ¾ inch plywood, 1/2 gypsum board or fire safing. See detail.
- 8) Provide combustion air for enclosed furnaces and hot water heaters by providing a 12" vent at the top and bottom of the wall. Provide an exhaust fan (75 cfm) for all bathrooms vented to the exterior air.

- 9) Provide natural or mechanical ventilation. Provide supply and return locations on plans.
- 10) Provide treated sill plates if using wood and hot dipped galvanized anchors and nails.
- 11) No paneling less than ¼ inch to be applied directly to stud or metal walls. All interior finishes must have a flame spread rating between 76-200 and a smoke developed rating 450 or less.

Required Inspections

- a) Rough Electric
- b) Rough Plumbing (if applicable)
- c) Rough Framing
- d) Insulation
- e) Final Electric
- f) Final Plumbing
- g) Final Fire Protection
- h) Final Building

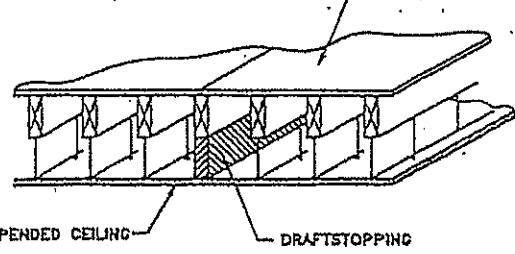
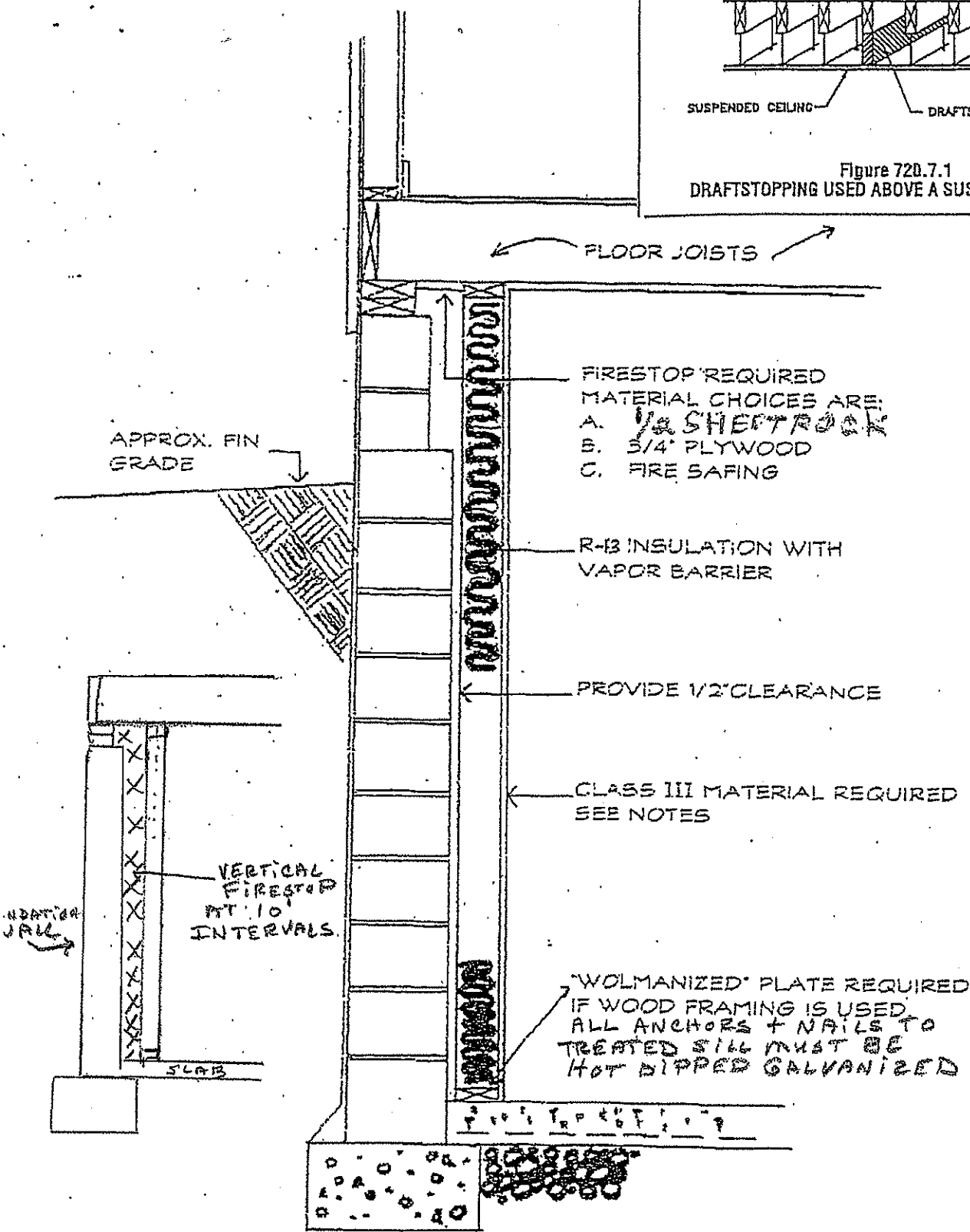

Figure 720.7.1
DRAFTSTOPPING USED ABOVE A SUSPENDED CEILING



Wall Section
Finished Basement Requirements
Scale 3/4" = 1'-0"

11/7/06

Scheduling Inspections

When Work is complete please contact the
South Plainfield Building Department for Inspections

Please have your permit # available when calling

Phone # - (908) 226-7640

Inspection Hours

| | | |
|----------|---------------------------------|---------------------|
| Building | Monday thru Friday | 9:30 am to 3:00 pm |
| Electric | Monday thru Friday | 1:00 pm to 4:00 pm |
| Plumbing | Monday, Wednesday and Friday | 10:30 am to 4:00 pm |

For Fire Inspections please call – (908) 756-4761